

6832 6670 1000Rs.



SUB-REGISTRAR, BURDWAN

Admissible under Rule 21 also under section 5 of the L.R. Act (N.A.T. Act) duly stamped/ exempt from/ does not require stamp duty under the Indian Stamp Act, 1899. Schedule IA No. Fees paid as under: Process fee in C.F.S.

16670

Rekha Deb

SUB-REGISTRAR, BURDWAN

বক্রমান-
ত্রি-অনিয়মিত
২০.০০০, ৫০০/-
স্বাক্ষর
স্বাক্ষর

কোমঃ:-
শ্রী অমীত মুখার্জী আর্থিক সিলে-৮ সুবর্ধ

কোমঃ আনন্দের কনিষ্ঠ শিশু কোমঃ-৮৫০০/-
২০১-৫১-১১ স্বাক্ষর কোমঃ-৮৫০০/-

A ২০১/ ১ ২০
২০১/২০
২০১/২০
২০১/২০

8230
 No. 8230 Burdwan-Treasury
 Sold to Suman Kumar Samanta
 On 18/3/86
 For Rs. 19760 (Rs. 20000 + 20% TDS) Band
 Stamp 18/3/86
 Burdwan Collector's Office



Presented for Registration
 at 12/11/86 M on the 28th
 day of July
 1986 at the Sub-Registration Office by
Rekha Deb
 for executant/claimant.

Rekha Deb
 W/o. Dr. Matilal Deb
 of Nat. Kana city
 P.O. 163, Cal-64.
 at present

to Rekha Deb
 DISTRICT SUB-REGISTRAR, BURDWAN
 28/7/86

Ben / Wife of
 of
 Thana
 District Burdwan
 by caste
 by profession

to Rekha Deb.

Matilal Deb
 W/o. Sankar Nath Deb

Ben / Wife of
 of
 Thana
 District Burdwan
 by caste
 by profession

Matilal Deb
 S/o Sankar Nath Deb
 28/7/86

DISTRICT SUB-REGISTRAR, BURDWAN



Rekha Del.

विक्रय:-

श्री बही-हरना देव

श्री-उत्तर-श्री बहीमान देव

वसिष्ठ-हिन्दू-देवता-पुस्तक

बाद-मान-देव-श्री-वि, वि, वि-२७७

कनिका-२४। २५-२६-श्री-दी-२५

नगर-द्वैत-श्री-श्री-३-देव-द्वैत-श्री-३

203
Burdwan-170001
Sold to *Lamin Kamin Samanta*
ON *18/7/86*
Rs. *1935-(1000+200+20+25+11)* *Buc*
Stamp Class *170001*
Burdwan Collection



DISTRICT REGISTRAR, BURDWAN

28/7/86



Rekha Del.

बन्धा साह विष्णु हनुमन्तु-

हनुमन्तु-मन्त्रिणः - कर्मभूषणः निरुद्ध

विष्णु-कर्म-विष्णु-कर्म-विष्णु-कर्म

विष्णु-कर्म-विष्णु-कर्म-विष्णु-कर्म

विष्णु-कर्म-विष्णु-कर्म-विष्णु-कर्म

873
Burdwan Treasury
Sold to *Amis Kumar Samanta*
18/12/86
on 1976 (1000 200 201 25+1) *Bue*
State Govt. *18/12/86*
Burdwan Collectorate



DISTRICT SUB-REGISTRAR, BURDWAN
20/12/86



Rekha Del.

ଅଧ୍ୟକ୍ଷାଣାମଃ ନିର୍ଦ୍ଦେଶଃ ୧୩୩୭-୧୬୯୯-୨୦୧୭/୧୮
 ଓଡ଼ିଶାରେ ଉପସ୍ଥାପିତ ଓ ସଫଳତାପୂର୍ଣ୍ଣ ଆରମ୍ଭିତ
 ଓଡ଼ିଶାରେ ୧୮.୦୯.୧୭ ଉପସ୍ଥାପନ କରାଯାଇଥିବା
 ଓଡ଼ିଶାରେ ୧୨.୧୨.୧୭ ଓଡ଼ିଶାରେ ୧୮.୧୨.୧୭ ଓଡ଼ିଶାରେ
 ଓଡ଼ିଶାରେ ୧୮.୧୨.୧୭ ଓଡ଼ିଶାରେ ୧୮.୧୨.୧୭
 ଓଡ଼ିଶାରେ ୧୮.୧୨.୧୭ ଓଡ଼ିଶାରେ ୧୮.୧୨.୧୭
 ଓଡ଼ିଶାରେ ୧୮.୧୨.୧୭ ଓଡ଼ିଶାରେ ୧୮.୧୨.୧୭

878
No. Burdwan-Treasurer
Sold to: ... Kumar Samanta
On: ... 18/9/08
Rs. 1000 = (1000) 200 + 200 + 500
Stamp Clerk
Burdwan Collector



DISTRICT SUB-REGISTRAR, BURDWAN

207782

873
Burdwan-Treasury
Sold to Jamir Kumar Samanta
18/1/86
Rs. 1456 = 1000 + 200 + 200 + 50 + 6
Stamp Clerk, 18/1/86
Revenue Collectors

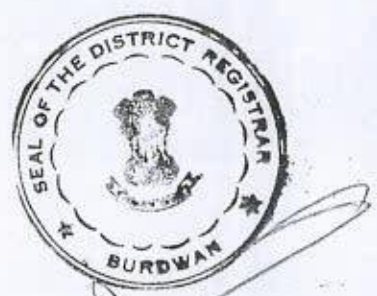

DISTRICT SUB-REGISTRAR, BURDWAN
20/1/86





DISTRICT SUB-REGISTRAR, BURDWAN

297/188

②

Book No. 114
Volume No. 179
Pages 173 to 176
Being No. 2676
For the year 19 88



DISTRICT SUB-REGISTRAR, BURDWAN

12.3.87

SITE PLAN SHOWING THE LAND SOLD TO SRI SAMIR KUMAR SAMANTA, S/O LATE

SUDHANSHU SHEKHAR SAMANTA, S/O RAMAKRISHNA ROAD, P.O. P.S. & DT. BURDWAN. BY Smt. REKHA DEB

W/O DR. MATILAL DEB, KSHUDIRAMNAGAR, P.O. P.S. & DT. MIDNAPORE IN MOUZA JAGATBERH, J.L. NO. 34, PART OF C.S. & R.S.

PLOT NO. 196. SUB-PLOT NO. 12A, C.S. KH. NO. 1/3 & R.S.

KH. NO. 182, P.S., DT. & SUB-REGISTRY OFFICE - BURDWAN.

SCALE - 40' FT = 1" IN.

REF. - LAND OF SRI SAMIR KR. SAMANTA - 12A.

AREA - 1821 SFT.

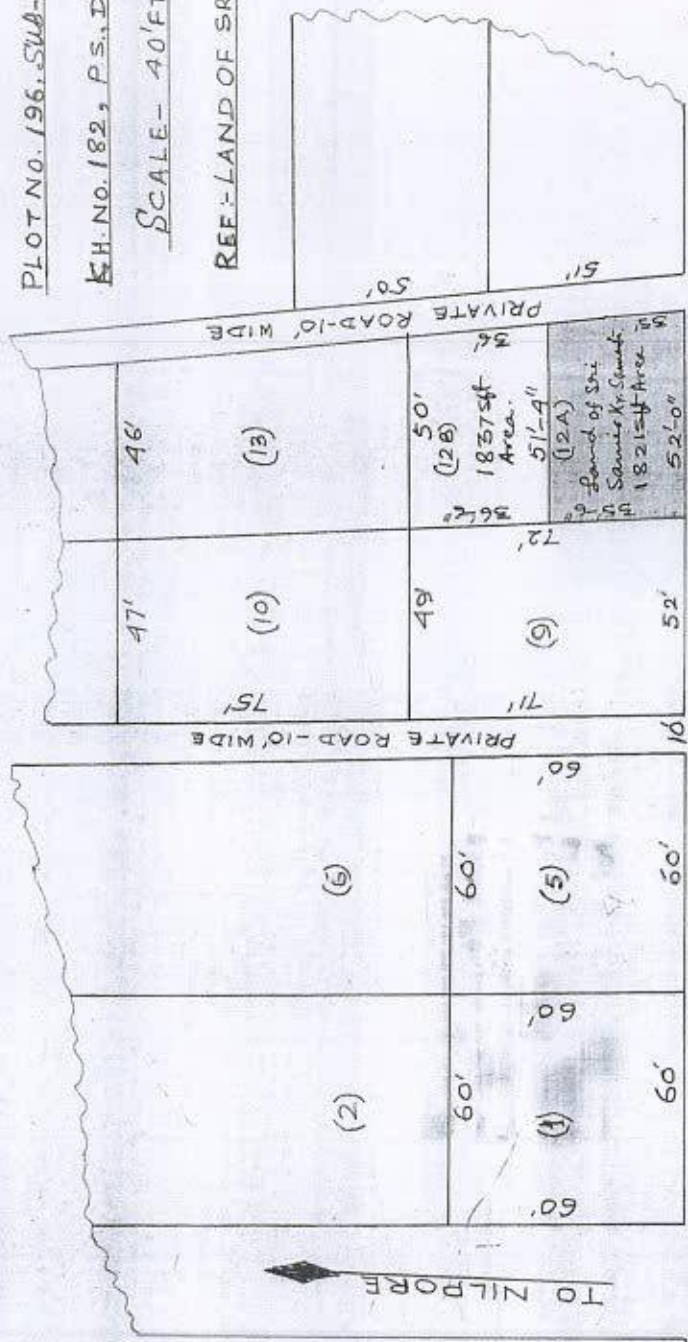

TO BALIDANGA

TO BECHARHAT

Rekha Deb

স্বাক্ষরিত: সত্যজিৎ কুমার মুখার্জী



[Faint, illegible handwritten text]

[Faint, illegible handwritten text]

[Faint, illegible handwritten text]

